

2. FITTING THE SPACER

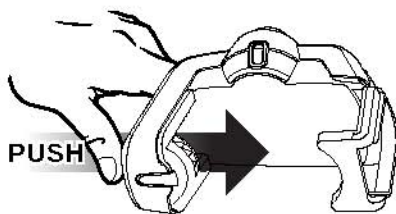

How to remove:

Push the back of the spacer to slide it out and remove it.

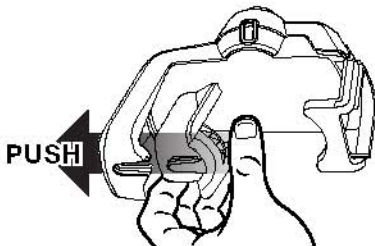

How to fit:

Slide the correct spacer into the slot to engage.

3. CHECK FITMENT

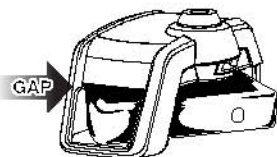

INCORRECT



CORRECT

FITTING INSTRUCTIONS

**IF using GPS unit in it's bracket,
ensure it is properly secured to windshield.**

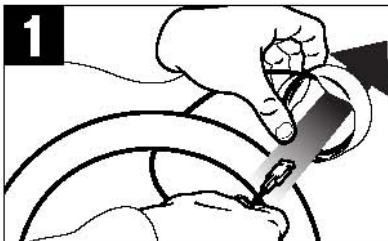
TO LOCK: FOLLOW STEPS 1 THROUGH TO 3.

Uncoil security cable. Loop security cable through steering wheel.

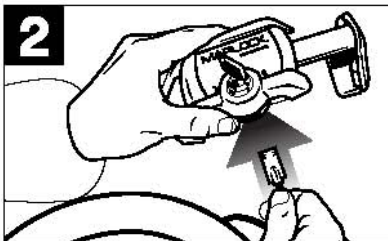

Clip security cable end into MAPLOCK™ device until you hear a click.



Extend MAPLOCK™ device. Place diagonally across the face of GPS unit and secure MAPLOCK™ to fit firmly and lock with key.

TO UNLOCK: REVERSE PROCEDURE